

Model
RP5000

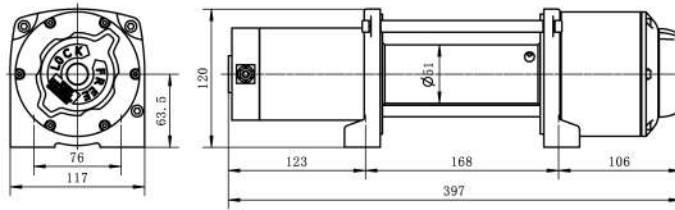

RP5000 Winch performance data (first layer of the drum)

Line pull		Line speed		Motor current (amp)	Line pull by layer			Cable Capacity	
Lbs	kgs	Ft/min	m/min		Layer	lbs	kgs	ft	m
0	0	20.7	6.3	34	1	5000	2270	11.5	3.5
2000	908	15.1	4.6	135	2	4080	1852	25.4	7.7
3000	1360	11.5	4.0	155	3	3446	1565	42	12.8
4000	1810	10.5	3.2	190	4	2983	1354	50	15.2
5000	2270	9.2	2.8	230					

Specifications

Model	RP5000	
	E16P05	E16P06
Rated line pull	5000 lbs (2268 kgs) single line	
Motor(permanent magnet)	12V DC input power: 3.8Hp(2.8kw)	
Gear Ratio	165:1	
Gear train	3-stage planetary	
Brake	Automatic load-holding brake	
Power in and power out	Yes	
Free Spooling	Yes	
Drum	Ø2.01" x5.4"(Ø50mmx137.5mm)	
Rope material	Steel cable	Synthetic rope
Rope dia. & length	Ø1/4"x50'(Ø6.3mmx15m)	
Hook(with safety latch)	1/4"	
Fairlead	Roller fairlead	Aluminum hawse fairlead
Winch dimension	15.62"x4.61"x4.72" (397mmX117mmX120mm)	
Mounting bolt pattern	3" x6.61"(76mmx168mm)	
IP rating	IP67	
N.W.(kgs)	15.3	13.19