

FEATURES & BENEFITS

Easy installation - outlet and pump body 360° rotate to suit your installation.

Threaded discharge nozzle with Multiple ports are available - 3/4" + 1", 1" + 1-1/8" straight fittings and 1-1/8" elbow fitting

Hidden Air Vents in the Body - helps prevent air locking in challenging plumbing installations and helps with the check valve.

Our best drain down levels ever as low as 10mm or 1/3". Traditional operated by switch or float switch.

Easy to clean - unique clever strainer design with 360° rotation function.

- High performance - Flow up to 1100 US gals per hour
- Low profile strainer - Leaves the bilge almost dry
- Low narrow design for tight/awkward bilge spaces
- Efficient operation - Very low power consumption
- Non-return valve included - to prevent backflow
- Traditional operated by switch or float switch.
- Marine grade silicon blocked, tin coated wiring
- Five-blade impeller to ensure high flow rate
- CE, RoHS, ISO 8846, ISO 8849 standards
- New innovative split quick-connect joint design removes and installs in seconds! No need to disconnect base or plumbing when replacing pump, which can meet the needs of most users.
- Easy to clean - easy to remove and replace for cleaning.
- Submersible and ignition protected
- Sealed efficient, long life motors
- Easy to clean - snap fit assembly
- Exclusive moisture tight seals
- Motor can be sold separately
- Stainless-steel motor shaft
- Anti-Airlock protection
- 2 Year Warranty
- Quiet operation

DETAILS

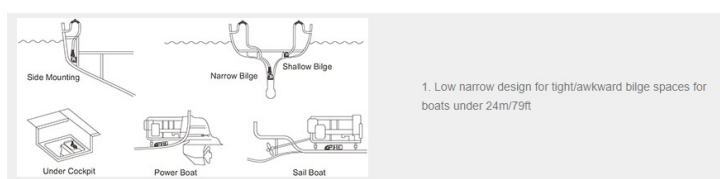

1. Low narrow design for tight/awkward bilge spaces for boats under 24m/79ft

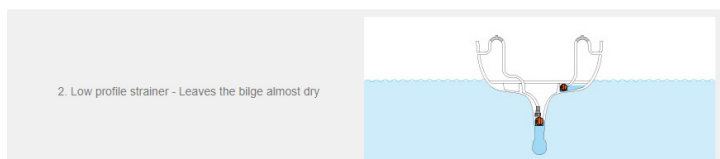

2. Low profile strainer - Leaves the bilge almost dry



3. New innovative split quick-connect joint design removes and installs in seconds! No need to disconnect base or plumbing when replacing pump, which can meet the needs of most users.

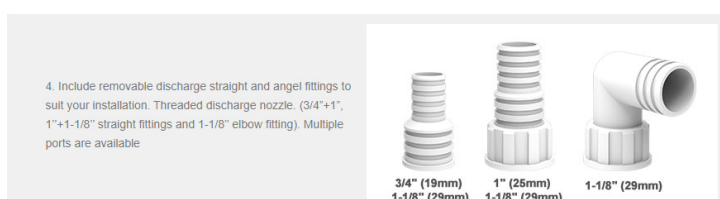

4. Include removable discharge straight and angel fittings to suit your installation. Threaded discharge nozzle. (3/4" + 1", 1" + 1-1/8" straight fittings and 1-1/8" elbow fitting). Multiple ports are available

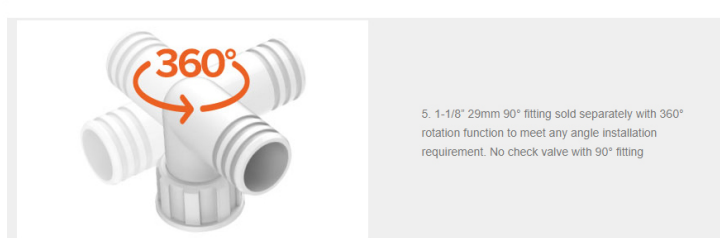

5. 1-1/8" 29mm 90° fitting sold separately with 360° rotation function to meet any angle installation requirement. No check valve with 90° fitting



6. The pump body is designed with a 360-degree rotation function, which can quickly adjust any angle to meet installation requirements



7. Motor can be sold separately

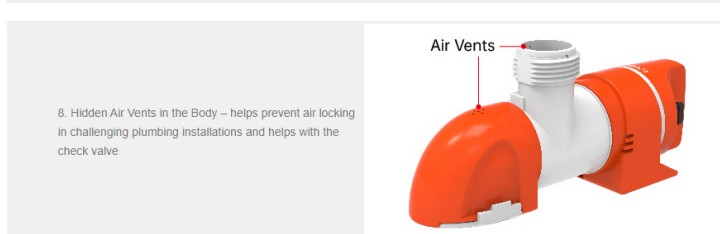

8. Hidden Air Vents in the Body - helps prevent air locking in challenging plumbing installations and helps with the check valve



9. Backflow Prevention - The non-return check valve prevents water left in the discharge from running back, keeping bilges dryer and cleaner

10. Installation

Mounting Directions:

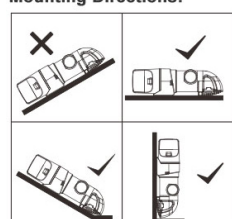

Screws:

The installation method is as shown on the left: First remove the motor assembly; Second install 2*M4 screws on the base; Third install the motor assembly.

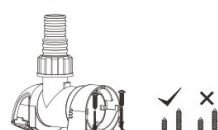

11. Wiring Diagrams

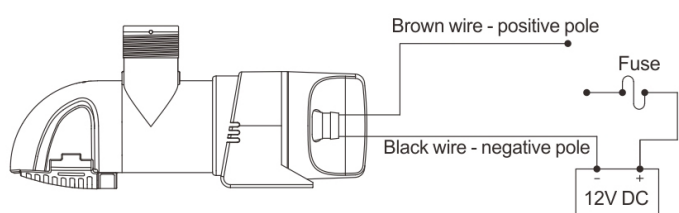

STANDARD PUMP CONFIGURATIONS

Model	Flow rate	Volts	Current	Head	Mode of Operation	Outlet Dia.	N.W./G.W.
SFBP1-G800-14C	800GPH	12V	3.2A	3.2m/10.5'	manual mode	3/4" (19mm)	0.35/0.51kg
SFBP2-G800-14C	800GPH	24V	2.0A	3.2m/10.5'		1" (25mm)	0.35/0.51kg
SFBP1-G1100-14C	1100GPH	12V	4.2A	4.0m/13'		1-1/8" (29mm)	0.35/0.51kg
SFBP2-G1100-14C	1100GPH	24V	3.0A	4.0m/13'		1-1/8" (29mm)	0.35/0.51kg

PERFORMANCE

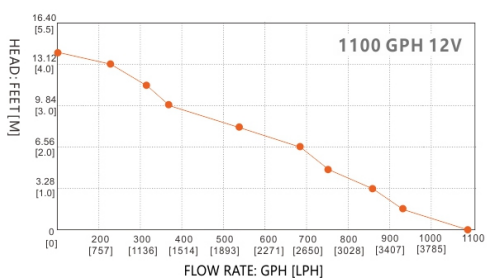

DIMENSIONS

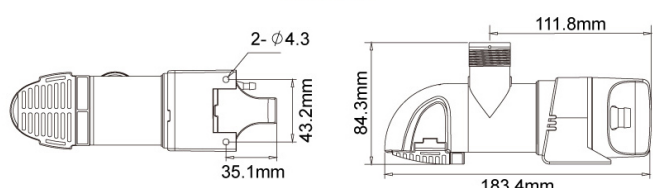

DETAILED COMPOSITION

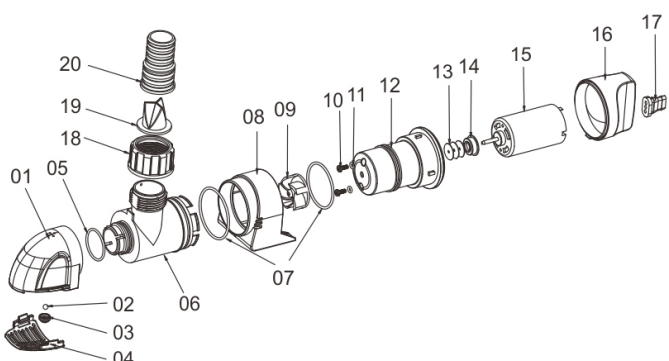

Key	Description	Quantity	Key	Description	Quantity
1	Filter Head	1	11	Screw Seal	2
2	Exhaust Head	1	12	Motor Cover	1
3	Exhaust Valve	1	13	Oil Seal	3
4	Filter Net	1	14	Oil Seal Seat	1
5	Inlet Seal Ring	1	15	Motor	1
6	Pump Chamber	1	16	Motor Back Cover	1
7	Pump Chamber Seal	2	17	Two-hole Line Card	1
8	Pump Base	1	18	Lock Nut	2
9	Impeller	1	19	Check Valve	1
10	Machine Screw M3*8	2	20	25-29mm Straight Fitting	1