

spinlock

DECKVEST LITE AND LITE+

170N (38LB) AUTOMATIC LIFEJACKET
LITE+ MODEL INCLUDES DECK HARNESS

- APPROVED TO ISO 12402-3
- HARNESS ATTACHMENT POINT
(DECKVEST LITE+ ONLY)
APPROVED TO ISO 12401
- AUTOMATIC INFLATION
- EASY RELEASE CROTCH STRAP
- OPTIONAL SPRAYHOOD
AND PYLON



www.spinlock.co.uk



Fitting

Deckvest Lite

A B C

Deckvest Lite +

A B C

A B C

Crotch Strap back attachment

A B C

Lifejacket inflation: UML Mk5

Manual

Auto

Oral inflation

A B

Whistle Location - Blow to operate.

A B

Lifting / Buddy Loop





Re-packing your Deckvest LITE/LITE+ See video at www.spinlock.co.uk

1. ABCDEF

Remove all air.

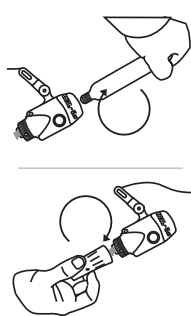
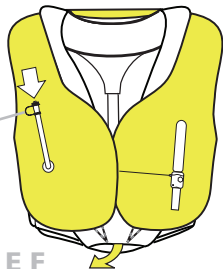
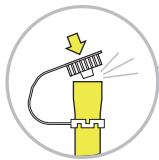

ABCDEF

Pull zips out.

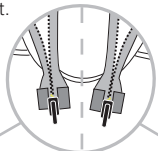

ABCDEF

Separate zip chain at yellow end section.

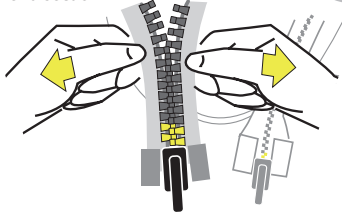

ABCDEF

Re-attach zips on side with firing head.

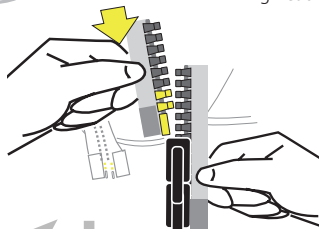

ABCDEF

Run this slider round to the firing head side.

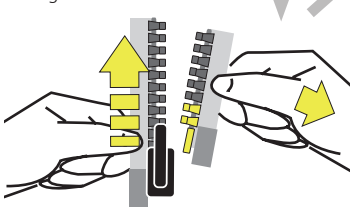

ABCDEF

Start running zip back round to close.

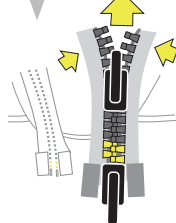

- 2.** Concertina bladder onto itself ensuring a smooth flow for the manual lanyard.
Place firing head in mesh pocket.

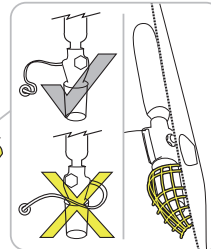
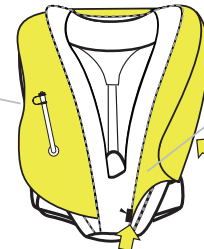
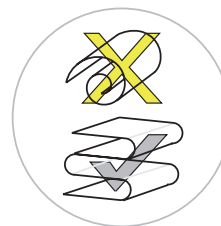

- 3.** Concertina top in.

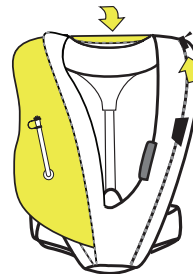

- 4.** Run zip round to close and fasten flap across breakout points.

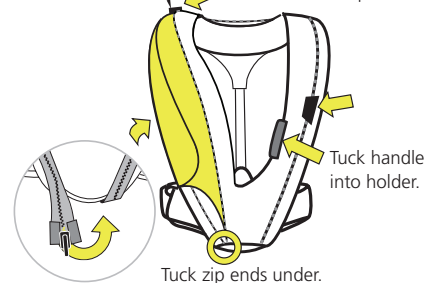

Tuck zip ends under.

Tuck handle into holder.

Sprayhood accessory*



Attached with buckle attachment.

*Not included





Contents

	Page no:
Re-packing your Deckvest LITE/LITE+	3-4
Approval conditions	5
Re-arming your Deckvest LITE/LITE+	5
Inflating and deflating your Deckvest LITE/LITE+	6
Maintaining your Deckvest LITE/LITE+	6-7
Testing your Deckvest LITE/LITE+	7
Safety notices	8-9
Inspection Record box	9

Approval Conditions

This Deckvest is approved to **ISO 12402-3** (150N) with the addition of a **ISO 12401** Deck Harness approval for the Deckvest LITE+ model. It is important to get into the habit of wearing your Deckvest. It is comfortable, safe and a pleasure to wear.

Minimum Buoyancy - 150N.

A lifejacket and harness only works correctly if it is fitted and secured correctly.

Inflatable lifejackets only become buoyant when inflated: they contain no inherently buoyant materials.

As user, it is your personal responsibility to understand the operation and maintenance requirements of your inflatable lifejacket and be familiar with its limitations.

Approval Conditions

The Deckvest LITE and LITE+ is an integrated CE approved lifejacket according to **ISO 12402-3** (150N). The Deckvest LITE+ is a CE approved Deck harness according to **ISO 12401**.

Re-arming your Deckvest LITE/LITE+

Remove cylinder and old firing cap by unscrewing anti clockwise. Check firing mechanism moves freely and is free from any contamination. Then replace first with a new cap and then with the new cylinder, ensuring a secure fit. Check / Replace the manual pull green indicator clip if required.

WARNING:

The deck safety harness and safety line may transmit very large forces. Only attach to strong hooking points or jack-lines.

The deck safety harness and safety line are intended to prevent the user falling overboard. They do not provide protection from falls at height.

It is unsafe to wear this harness loose, the harness shall be worn tightly in order to be effective.

Inflating your Deckvest LITE/LITE+

It is recommended that the following inflation procedures are followed:

1. MANUAL INFLATION

To manually inflate the lifejacket, sharply pull the rubber handle downwards. The CO₂ gas cylinder should inflate the bladder within seconds.

2. ORAL INFLATION

To inflate the lifejacket by mouth, locate the oral inflation tube by opening the zip at the yellow breakout point on the front panel of the lifejacket. Then after removing the end cap, blow into the tube until the lifejacket is fully inflated.

3. AUTOMATIC INFLATION

Inflation should occur automatically within seconds of the inflator being submerged. The automatic capsule is designed to activate a sprung pin to puncture the CO₂ cylinder and inflate the bladder.

CO₂ Cylinder size - Model 170N: use 33g

CORRECTING PRESSURE VARIANCE

With variations in air or water temperatures, topping up by oral inflation may be required to maintain full buoyancy especially after prolonged immersion.

Deflating your Deckvest LITE/LITE+

To deflate the lifejacket, invert the oral-inflation tube end cap and insert it into the valve. Holding the cap firmly in this position, gently squeeze the lifejacket until all air or gas has been expelled. Return the cap to its normal position.

WARNING: Using the CO₂ inflation when your jacket is already fully inflated can over-pressurise and damage your lifejacket.

Maintaining your Deckvest LITE/LITE+

Maintaining this Deckvest should be the responsibility of one sole user. As the user you are strongly advised to familiarise yourself fully with the Deckvest before using it as a lifejacket.

We advise that you follow a 3-level checking routine, easily carried out by yourself:

- 1. During Use**, check buckles and other fastenings regularly.
- 2. Before and after use**, examine for damage or excessive abrasion, wear, tear or contamination. Particular attention must be paid to the stitching and webbing, including the less accessible areas.
- 3. Every three months**, carry out a complete inspection, checking:
 - a. The fabric:** for cuts, tears, abrasion and damage caused by heat, chemicals etc.
 - b. The lifejacket:** to check for leaks, inflate your lifejacket through the oral tube until firm and leave for 24hrs. Any loss of firmness indicates leakage and means it is unsafe.

To check the oral valve, fully inflate the lifejacket and hold the tube under water. If bubbles appear, deflate and re-inflate to test.

If a leak persists, do not use your lifejacket until it has been professionally serviced at your nearest service centre.
 - c. The components:** remove and inspect all components. Ensure CO₂ cylinder is screwed in tight.





WARNING:

If in doubt, send your Deckvest LITE/LITE+ to your nearest service centre for evaluation and/or servicing.

If you are not completely confident about undertaking the self-inspection and servicing of your lifejacket in accordance with these instructions, you must not use your lifejacket again until it has been professionally inspected and serviced. (For details of your nearest service centre see www.spinlock.co.uk).

Any modification or repair to any part of the Deckvest LITE/LITE+ is expressly forbidden unless carried out by Spinlock Ltd.

Testing your Deckvest LITE/LITE+

You should always test the inflation of your lifejacket to ensure you are fully aware of how it functions.

This can be done with the Oral, Manual or Automatic inflators.

If planning to test the lifejacket with the Oral inflator you will not need any spare parts or rearming kits as long as you remove the CO₂ cylinder and automatic capsule before entering the water.

If you are a weak swimmer it is strongly recommended to use an automatic lifejacket or an inherently buoyant device.

1. Put on the Deckvest LITE/LITE+ and adjust to fit.
2. Stand in shallow water or swimming pool, just deep enough for your head to be above the surface.
3. **Inflation:**
 - Automatic:** lifejacket should fully inflate within five seconds of water contacting the firing head.
 - Manual:** lifejacket can be activated by a sharp pull on the inflation handle.
 - Oral inflation:** Ensure that cylinder and firing head have been removed before entering the water. Open the lifejacket cover from the zip breakout point, locate the oral inflator, remove cap and blow through tube.
4. After testing completely deflate the lifejacket using the oral inflator.
5. Let the Deckvest dry thoroughly. Do not expose to direct heat.

REMEMBER: RE-ARM AND RE-PACK THE LIFEJACKET IN ACCORDANCE WITH THESE INSTRUCTIONS - See video at www.spinlock.co.uk

WE RECOMMEND THAT THE AUTOMATIC CAPSULE (PART NO. DW-RAK) IS REPLACED ANNUALLY. ALSO UNSCREW AND INSPECT THE THREADED END OF THE CO₂ CYLINDER TO CONFIRM IT IS UNUSED.

(EN) English

Safety Notices

FITTING ADJUSTMENTS (PAGE 1)

Put on over head, A. Feed metal buckle through itself. B. Pull chest belt webbing tight. - It is unsafe to wear any lifejacket loosely. Deckvest chest belt should be positioned above lowest point of rib cage. C. Attach crotch strap - passing through legs before fastening plastic buckle in pocket on front.

GENERAL INFORMATION

Important notice: Specific training is essential before use.

Read this notice carefully before use. This technical notice illustrates ways of using this product. Many types of misuse exist which are impossible to list or even imagine. In case of doubt or any problem of understanding, contact Spinlock. Water sports are dangerous activities which may lead to severe injuries or even death. Adequate training in appropriate safety techniques and methods is essential and acquiring this training is your own responsibility. You personally assume all risks and responsibilities for all damage, injury or death which may occur during or following wrong use of our products in any manner whatsoever. If you are not able, or are not in a position to assume this responsibility or to take such risks do not use this equipment.

MAJOR FALLS

In the event that your full body weight is dropped a distance and then stopped, do not continue to use this product. Even if no external changes are visible, internal damage may have reduced its strength and its margin of safety. Do not hesitate to contact Spinlock in case of doubt.

WARNING: The deck safety harness and safetyline are intended to prevent the user falling overboard. They do not provide protection from falls at height. In a fall the deck safety harness and safety line may transmit very large forces to the anchorage point. For full guidance on the use of the safety cutter please visit: www.spinlock.co.uk

USE

This product must only be used by competent and responsible persons, or those placed under the direct and visual control of a competent and responsible person. Check that this product is compatible with other components of your equipment. To prolong the life of this product, care in use is necessary. Avoid rubbing against abrasive surfaces or sharp edges. 150N: This level is intended for general application or for use with foul weather clothing. It will turn an unconscious person into a safe position and requires no subsequent action by the user to maintain this position. Full performance may not be achieved if using watertight/waterproof clothing or in other circumstances. Gas cylinders are dangerous goods and should be kept away from children and not misused. Do not use as a cushion. Train yourself in the use of the device. Compatible with safety harness and clothing. Lite - Compatible with safety harness and clothing. Lite + Compatible with approved safety lines and clothing. Anchorage point is located at the centre of the chest. Ensure no sharp edges on safety line attachment point. Use with an approved personal safety line only. Attach to Jack line / fixed eyes. Anchorage points must be able to withstand forces of more than 1 tonne. Never attach to lifelines / standing or running rigging. This is not a PFD until fully inflated.

WARNING: WHEN NOT CORRECTLY FITTED, THIS DECKVEST LITE/LITE+ MAY NOT PERFORM AS A LIFEJACKET AND MAY ENDANGER THE USER.

CLEANING, MAINTENANCE, STORAGE

Remove gas cylinder and automatic components and then clean by hand and rinse in clean fresh water (maximum temperature 30° C). Dry in a cool, ventilated dark room. Grease spots may be removed with trichlorethylene. Webbing shrinks very slightly in drying. Always carry and store your Deckvest in a well ventilated bag. Though UV protected, this product is best stored away from direct light, in a well ventilated place away from extreme temperatures.

CHEMICALS

All chemicals (including petrol, battery acid, corrosive materials and solvents) should be regarded as harmful. If your Deckvest comes in contact with chemicals, please notify Spinlock, stating the precise chemicals concerned. We will investigate and give our advice.



LIFETIME = SHELF LIFE + USEFUL LIFE

After first use this product should last 5 years. Certain environmental elements will considerably accelerate wear: salt, sand and chemicals.

In exceptional circumstances, wear or damage could occur on the first use which reduces the lifetime of the product to that one, single use. Shelf-life of this product in good condition is up to 3 years before first use.

TEMPERATURE

Use this product only above a minimum of -30° C and below a maximum of +60° C. When the temperature is below freezing, even a fully charged cylinder may not adequately inflate your lifejacket. If this occurs use the oral tube to manually top up your lifejacket after the CO₂ has been discharged (and not before).

DISINFECTING THE PRODUCT

When necessary, use a disinfectant that is compatible with polyamide, polyester, polycarbonate, PVC etc.

Use diluted with clean water at a maximum temperature of 30° C. After soaking for an hour, rinse in clean cold water. Dry slowly, away from direct heat.

RESPONSIBILITY

Spinlock is not responsible for the consequences, direct, indirect or accidental, or any type of damage befalling or resulting from the use of its products.

WARRANTY

This Deckvest qualifies for a special Spinlock Warranty lasting five years when you register online as first owner. Full details of how this operates, what it covers and does not cover are important to note and are explained on the Registration homepage www.spinlock.co.uk Certain environmental elements will considerably accelerate wear: salt, sand, moisture, chemicals. In exceptional circumstances, wear or damage could occur on the first use which reduces the lifetime of the product to that one single use. See www.spinlock.co.uk for full details.

Inspection Record

(EN) Purchase date :
(F) Date de l'achat :
(D) Kaufdatum :
(IT) Data di acquisto :
(ES) Fecha de compra :
(NL) Aankoop datum :
(DK) Købs dato :
(S) Köpdatum :
(SLO) Datum nakupa :
(N) Kjøpsdato :

(EN) Date of first use :
(F) Date de la première utilisation :
(D) Datum der ersten Verwendung :
(IT) Data del primo utilizzo :
(ES) Fecha de la primera utilización :
(NL) Datum eerste gebruik :
(DK) Dato for ibrugtagning :
(S) Första användnings datum :
(SLO) Datum prve uporabnik :
(N) Dato ved første gangs bruk :

Date	Approved



(EN) Temperature
(FR) Température
(DE) Temperatur
(IT) Temperatura
(ES) Temperatura
(NL) Temperatuur
(DK) Temperatur
(S) Temperatur
(SLO) Temperatura
(N) Temperatur

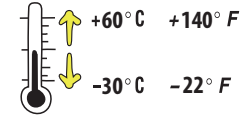
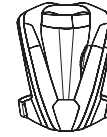

(EN) Storage
(FR) Stockage
(DE) Lagerung
(IT) Conservazione
(ES) Almacenamiento
(NL) Berging
(DK) Opbevares
(S) Forvaring
(SLO) Shranjevanje
(N) Lagring

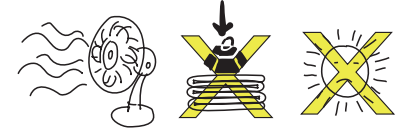

(EN) Dangerous products
(FR) Produits dangereux
(DE) Gefährliche Produkte
(IT) Prodotti pericolosi
(ES) Productos peligrosos

(NL) Gevaarlijke producten
(DK) Farlige væsker
(S) Farliga produkter
(SLO) Nevarni izdelki
(N) Farlige produkt

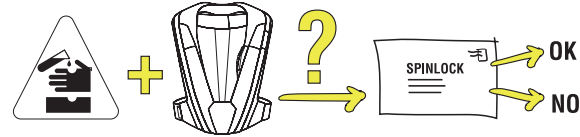

(EN) Cleaning / Disinfection
(FR) Nettoyage / Désinfection
(DE) Reinigung / Desinfektion
(IT) Pulizia / Disinfezione
(ES) Limpieza / Desinfección

(NL) Reiniging / Ontsmetting
(DK) Rengøres / Decifceres
(S) Rengöring/ Desinfektion
(SLO) Čiščenje/ razkuževanje
(N) Rengjøring/ Desinfeksjon

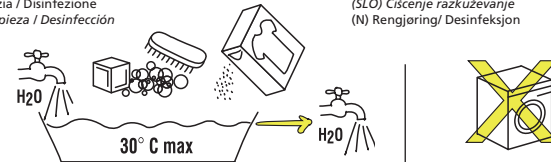

(EN) Drying
(FR) Séchage
(DE) Trocknen
(IT) Asciugamento
(ES) Secado

(NL) Het drogen
(DK) Tørrer
(S) Torkning
(SLO) Sušenje
(N) Tøking

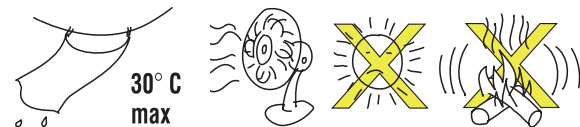

150N: Specified for offshore, foul weather clothing.

Deckvest LITE/LITE+ Serial number

Please register your Deckvest LITE/LITE+ serial number now at: www.spinlock.co.uk

ESSENTIAL INFORMATION: DO NOT REMOVE UNTIL SOLD.

It is essential you read these instructions before using your Deckvest LITE/LITE+.

WARNING:

WHEN NOT CORRECTLY FITTED, THIS PRODUCT MAY NOT PERFORM AS A LIFEJACKET OR HARNESS, RISKING SERIOUS DANGER TO THE USER.

For users aged above 16 years and weighing not less than 50 kg.

Do not use for white water paddling or with personal watercraft.

Do not use as a cushion.

Gas cylinders are dangerous goods. They should be kept out of reach of children and not be misused.

Train yourself in the use of the device.

CE

0514

ISO 12402-3 - 150N Lifejacket

ISO 12401 - Deck Harness - Deckvest Lite +



Chest size:
60-145cm



50kg+



DECKVEST LITE/LITE+ AUTOMATIC GAS INFLATION

This device is designed to inflate automatically upon immersion. Pulling the manual inflation handle will also activate the inflation mechanism or it can be inflated by blowing into the oral inflation tube. It can be converted to non-automatic operation using a Spinlock Deckware Series Manual Conversion Kit (DW-MAK).

MANUFACTURED BY

Spinlock Ltd
41 Birmingham Road
Cowes PO31 7BH
United Kingdom

The Spinlock Deckvest LITE/LITE+ is extensively protected under various National, European and International Patents and Design Rights owned by Spinlock Ltd.

For continuously updated user guidance go to www.spinlock.co.uk

3R679A_12